

Design/System/Construction/Assembly Usage Disclaimer

- Authorities Having Jurisdiction should be consulted in all cases as to the particular requirements covering the installation and use of UL Certified products, equipment, system, devices, and materials.
 - Authorities Having Jurisdiction should be consulted before construction.
 - Fire resistance assemblies and products are developed by the design submitter and have been investigated by UL for compliance with applicable requirements. The published information cannot always address every construction nuance encountered in the field.
 - When field issues arise, it is recommended the first contact for assistance be the technical service staff provided by the product manufacturer noted for the design. Users of fire resistance assemblies are advised to consult the general Guide Information for each product category and each group of assemblies. The Guide Information includes specifics concerning alternate materials and alternate methods of construction.
 - Only products which bear UL's Mark are considered Certified.
-

BXUV - Fire Resistance Ratings - ANSI/UL 263 Certified for United States

BXUV7 - Fire Resistance Ratings - CAN/ULC-S101 Certified for Canada

See General Information for Fire-resistance Ratings - ANSI/UL 263 Certified for United States
Design Criteria and Allowable Variances

See General Information for Fire Resistance Ratings - CAN/ULC-S101 Certified for Canada
Design Criteria and Allowable Variances

Design No. **W310**

May 25, 2022

Non-Load Bearing Wall Rating - 2 Hr.

Finish Rating - 47 min.

Fire and Finish Rating from Exposed Face Only

*** Indicates such products shall bear the UL or cUL Certification Mark for jurisdictions employing the UL or cUL Certification (such as Canada), respectively.**

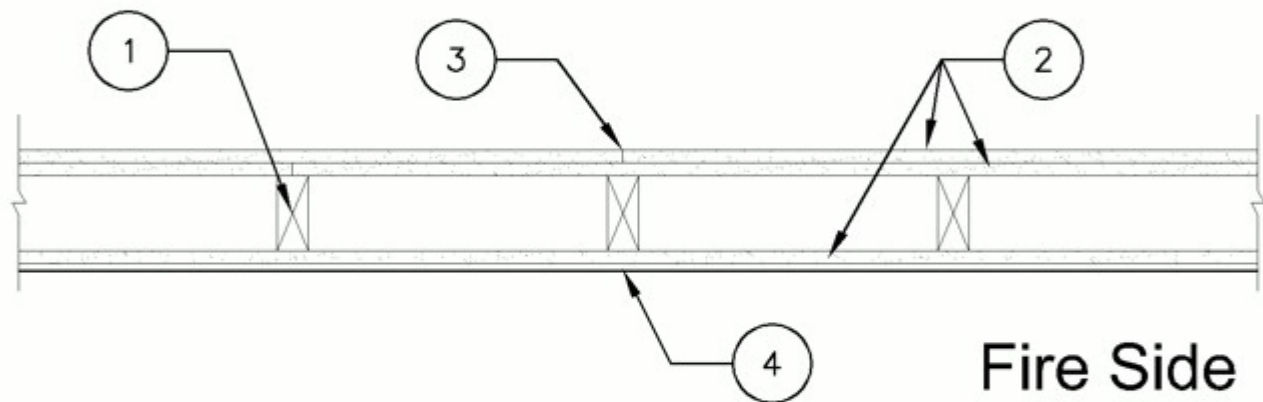

1. **Wood Studs** — Nom 2 by 4 in. spaced 16 in. OC max, with blocking installed at mid-height.

2. **Gypsum Board* — Non-Fire Side** — Two layers of paper faced, 5/8 in. thick gypsum board applied vertically. First layer fastened to studs with 1-1/4 in. Type W drywall screws spaced 8 in. OC along the perimeter and in the field. Second layer fastened to studs with 2 in. Type W drywall screws spaced 8 in. OC along the perimeter and in the field. Joints in face layer staggered with joints in base layer. Fasteners in face layer offset 4 in. from fasteners in base layer.

Fire Side — One layer of paper faced, 5/8 in. thick gypsum board installed vertically and fastened to studs using 1-1/4 in. long Type W screws spaced 8 in. OC along perimeter and in the field. Joints offset with joints of base layer on opposite side.

AMERICAN GYPSUM CO — Types AGX-1, AG-C, AGX-11, LightRoc

BEIJING NEW BUILDING MATERIALS PUBLIC LTD CO — Type DBX-1

CABOT MANUFACTURING ULC — Type X, 5/8 Type X, Moisture Resistant Type X, Gypsum Sheathing Type X, Mold & Mildew Resistant Type X and Mold & Mildew Resistant AR Type X

CERTAINTED GYPSUM INC — Type C, Type X-1

CGC INC — Types AR, C, IP-AR, IP-X1, IP-X2, IPC-AR, SCX, SHX, ULIX, ULX, USGX, WRC, WRX

CERTAINTED GYPSUM INC — Types LGFC2A, LGFC6A, LGFC-C/A, LGLLX, CLLX

GEORGIA-PACIFIC GYPSUM L L C — Types 5, 6, GPFS6, LS, TG-C

NATIONAL GYPSUM CO — Types eXP-C, FSK, FSK-C, FSK-G, FSW, FSW-3, FSW-5, FSW-8, FSW-C, FSW-G, FSMR-C, FSL, RSX

PABCO BUILDING PRODUCTS L L C, DBA PABCO GYPSUM — Types C, PG-2, PG-3, PG-3W, PG-4, PG-5, PG-5W, PG-5WS, PG-9, PG-11, PG-C or PGS-WRS

PANEL REY S A — Types PRC, PRC2, PRX, RHX, MDX, ETX, GREX, GRIX

SIAM GYPSUM INDUSTRY (SARABURI) CO LTD — Type EX-1

THAI GYPSUM PRODUCTS PCL — Type C or Type X

UNITED STATES GYPSUM CO — Types AR, C, IP-AR, IP-X1, IP-X2, IPC-AR, SCX, SHX, ULIX, ULX, WRC, WRX

USG BORAL DRYWALL SFZ LLC — Types C, SCX

USG MEXICO S A DE C V — Types AR, C, IP-AR, IP-X1, IP-X2, IPC-AR, SCX, SHX, ULX, WRC, WRX

3. Gypsum Finishing System — (Permitted on Non-Fire Side Only) — Vinyl, dry or premixed joint compound, applied in two coats to joints and screw-heads. Nom 2 in. wide paper tape embedded in first layer of compound over all joints.

4. Mastic and Intumescent Coating* — (Required on Fire Side) — Intumescent coating spray applied to the surface of the exposed face of the wall at an average measured thickness of 43 mils. The effect on the fire-resistance rating of the wall caused by any covering that would interfere with the expansion of the mastic and intumescent coating during a fire has not been investigated. Average thicknesses to be determined with the Type Positector 200C Defelsko gauge in areas away from framing members at a minimum frequency of 20 measurements within a 100 sq. ft. area per every 1,000 sq. ft. of total application area.

FLAMEOFF COATINGS INC — Type FlameOFF Fire Barrier. Investigated for Interior Conditioned Space and Interior General Purpose. Also investigated for UL 2431 exterior Salt Spray and Industrial Atmosphere exposures when used with Type Enduratone topcoat (item 5).

5. Top Coat – (Not Shown) Not required for Interior Conditioned Space Purpose. For Interior General Purpose Type FlameOFF WB Topcoat applied over the intumescent coating at 10 mil thickness or Type Enduratone Series 1028 (White) by Tnemec applied over the intumescent coating at 4 mil thickness.

*** Indicates such products shall bear the UL or cUL Certification Mark for jurisdictions employing the UL or cUL Certification (such as Canada), respectively.**

Last Updated on 2022-05-25

The appearance of a company's name or product in this database does not in itself assure that products so identified have been manufactured under UL Solutions' Follow - Up Service. Only those products bearing the UL Mark should be considered to be Certified and covered under UL Solutions' Follow - Up Service. Always look for the Mark on the product.

UL Solutions permits the reproduction of the material contained in Product iQ subject to the following conditions: 1. The Guide Information, Assemblies, Constructions, Designs, Systems, and/or Certifications (files) must be presented in their entirety and in a non-misleading manner, without any manipulation of the data (or drawings). 2. The statement "Reprinted from Product iQ with permission from UL Solutions" must appear adjacent to the extracted material. In addition, the reprinted material must include a copyright notice in the following format: "©2023 UL LLC."